

Plan

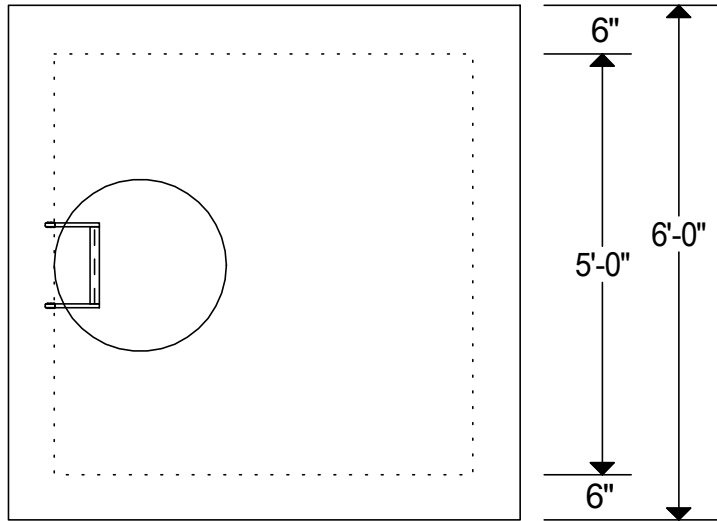

Elevation

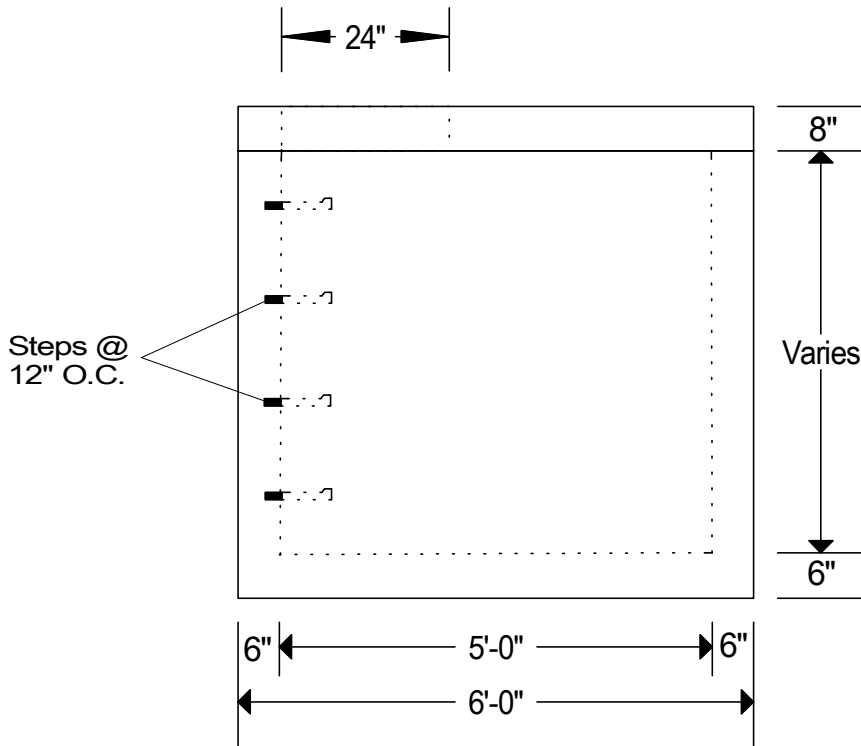

Notes:

Reinforcing: Walls & Floor #4 Rebar @ 12" O.C.E.W.  
& Cover #5 Rebar @ 8" O.C.E.W.

Weight: Walls & Floor 10,700 lbs. (4'-8" I.D.) & Cover 3,800 lbs.

Lifting Plan: Walls Use Utility Anchors (PL54G)  
& Cover Uses All Purpose Anchors (PLGP387G).

Available With Sump, End Bells, Ground Wire, Pulling Eyes & Cable Racks.  
H-20 Loading.

5,000 P.S.I. Minimum Strength Concrete.

We Produce A Green And Environmentally Friendly Product.

303-936-4817

5' x 5' Utility Box  
W/ Steps & 8" Flat Cover  
No Scale Page 49