

Plan

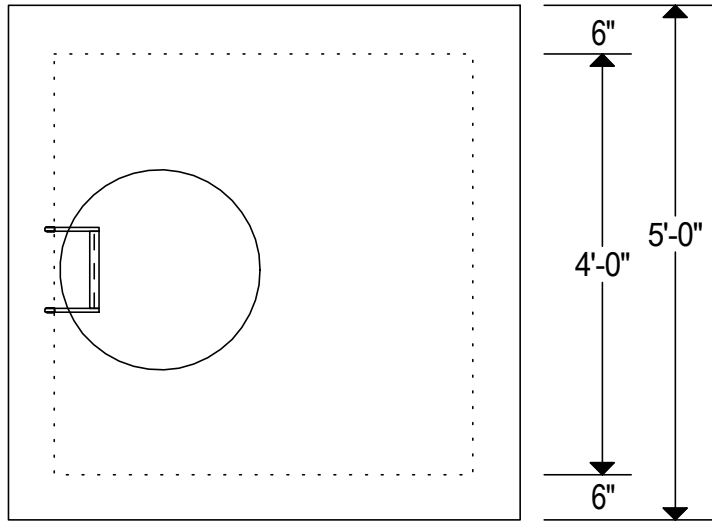

Elevation

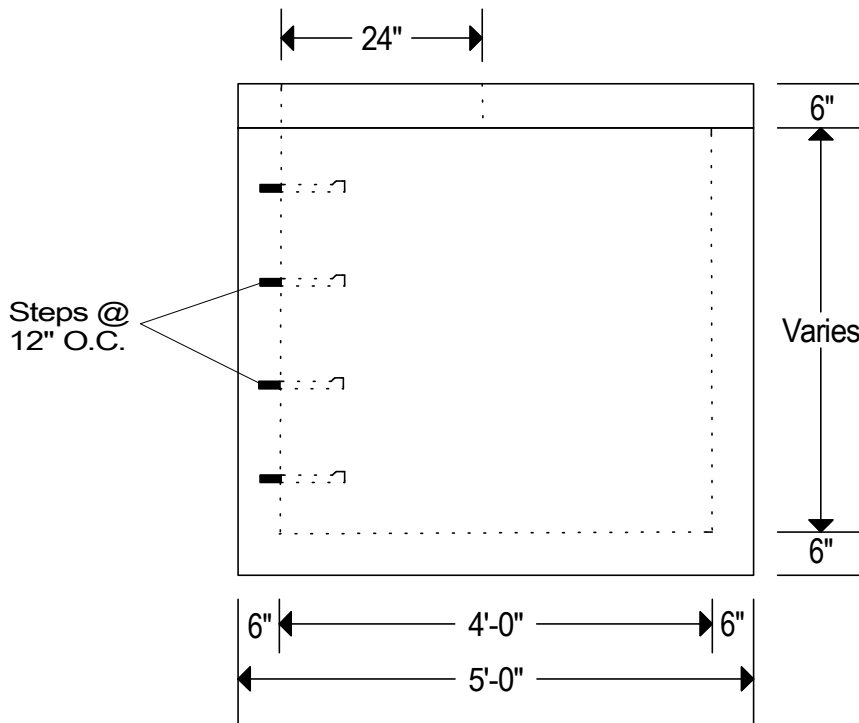

Notes:

Reinforcing: Walls & Floor #4 Rebar @ 12" O.C.E.W.
 & Cover #5 Rebar @ 8" O.C.E.W.
 Weight: Walls & Floor 8,000 lbs. (4'-6" I.D.). & Cover 2,000 lbs.
 Lifting Plan: Walls Use Utility Anchors (PL54G).
 & Cover Uses All Purpose Anchors (PLGP387G).
 Available With Sump, End Bells, Ground Wire, Pulling Eyes & Cable Racks.
 H-20 Loading.
 5,000 P.S.I. Minimum Strength Concrete.
 We Produce A Green And Environmentally Friendly Product.



303-936-4817

4' x 4' Utility Box
 W/ Steps & 6" Flat Cover
 No Scale Page 48