

Elevation

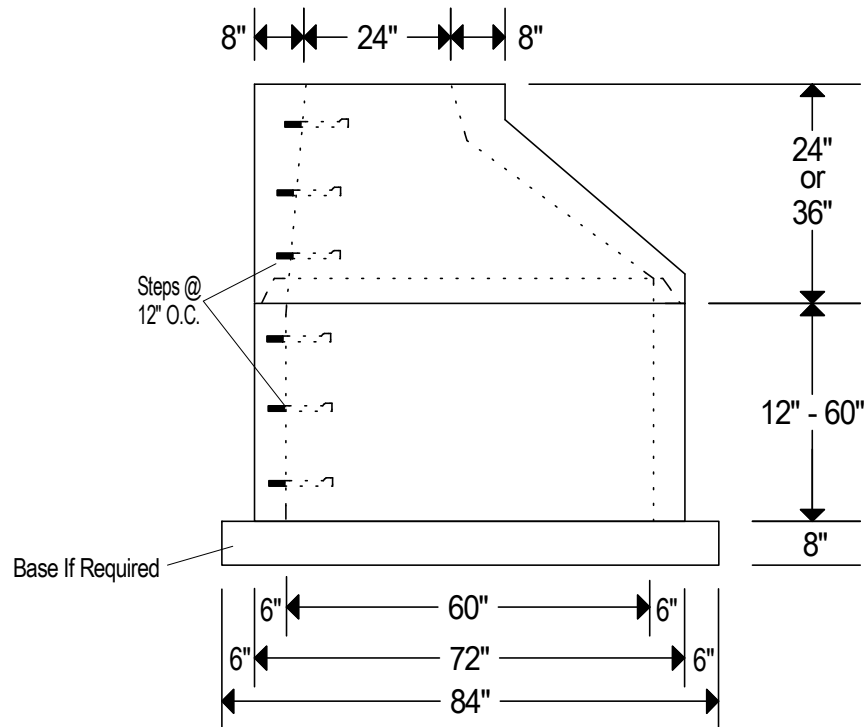

60" x 13" Insert Cover
With 24" Opening

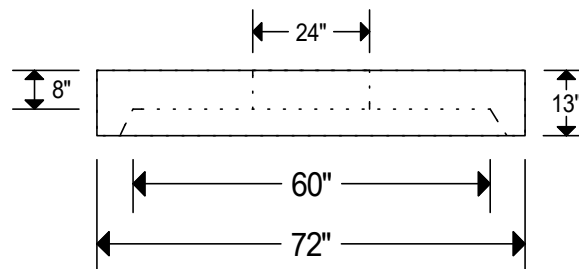

Notes:

Reinforcing: Manhole, Cone, & Cover Meet ASTM-C478.

Weight: Manhole 1,300 lbs. Per Foot & Cone Up To 3,900 lbs.

Insert Cover 2,800 lbs. & Base 3,800 lbs.

Lifting Plan: Manhole, Base & Cone Use Utility Anchors (PL66G)

& Insert Cover Uses All Purpose Anchors (PLGP387G)

Plastic Manhole Steps Included, Holes As Required And Rubber Boots Are Available.

Insert Cover Opening Can Be In The Center Or Offset For Steps.

5,000 P.S.I. Minimum Strength Concrete.

We Produce A Green And Environmentally Friendly Product.



60" ASTM Manhole Material
W/ Eccentric Cone & Insert Cover
No Scale
Page 23