

Plan

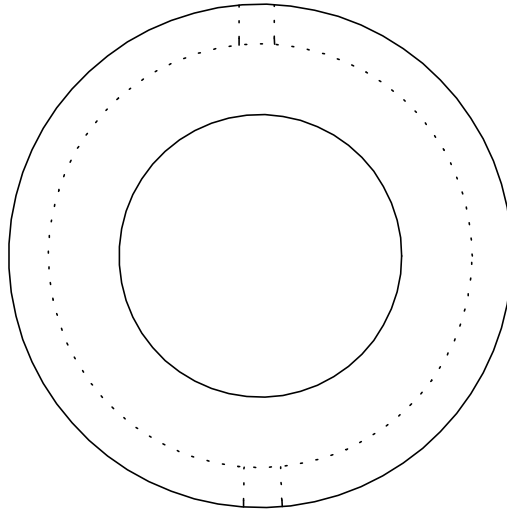

Elevation

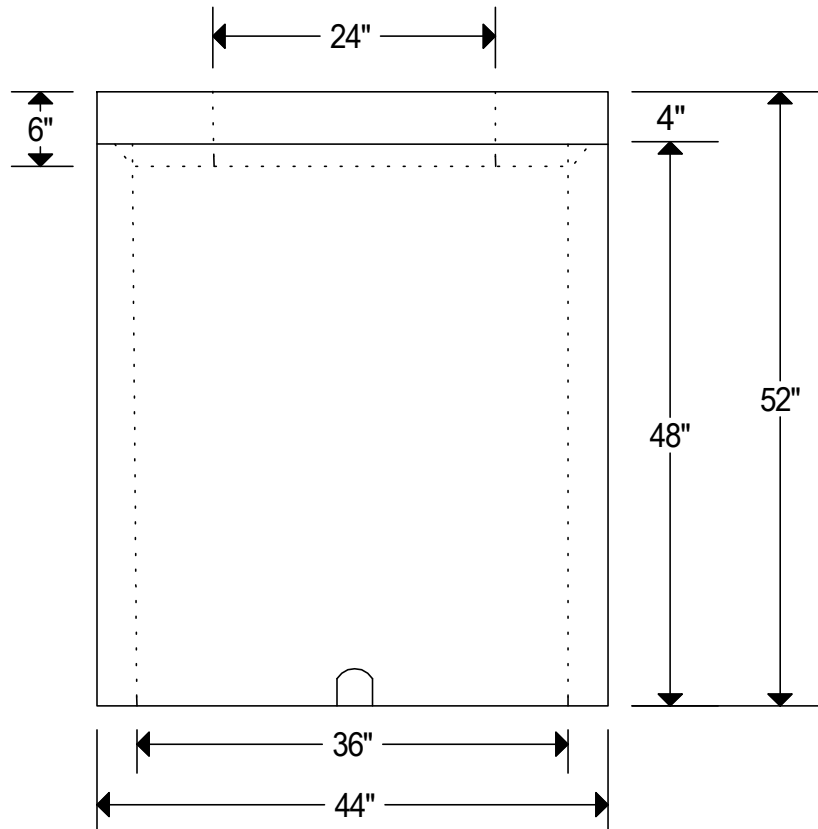

Notes:

Reinforcing Meets ASTM C478.

Weight: Bottom 1,540 lbs. & Cover 675 lbs.

Lifting Plan: Bottom Uses 3/4" Flared Ferrule Insert (C1342516CW)
& Cover Uses All Purpose Anchors (PLGP387G)

Includes Two 5" x 3" Slots.

5,000 P.S.I. Minimum Strength Concrete.

We Produce A Green And Environmentally Friendly Product.



36" Water Meter Pit
With Insert Cover
No Scale Page 2